



Uppingham Avenue

Stanmore

£2,000 Per month

Davidson Frost-Wellings are pleased to present this newly refurbished two-bedroom semi-detached bungalow, ideally situated within easy reach of Canons Park and Queensbury Tube Stations.

This delightful home features a bright and spacious reception room, a fully fitted kitchen, two generously sized bedrooms and separate family bathroom.

Further benefits include a large rear garden with a patio area perfect for outdoor entertaining, a side garage and a private driveway with space for two cars.

Harrow council tax band D
Available immediately
Deposit of £2,250 at the asking price

Viewing

Please contact our Davidson Frost-Wellings Office on 020 8954 8806 if you wish to arrange a viewing appointment for this property or require further information.

- Two bedrooms
- Bungalow
- Garage to the side
- Excellent location
- Newly refferbished
- Parking for two cars



Floor Plan

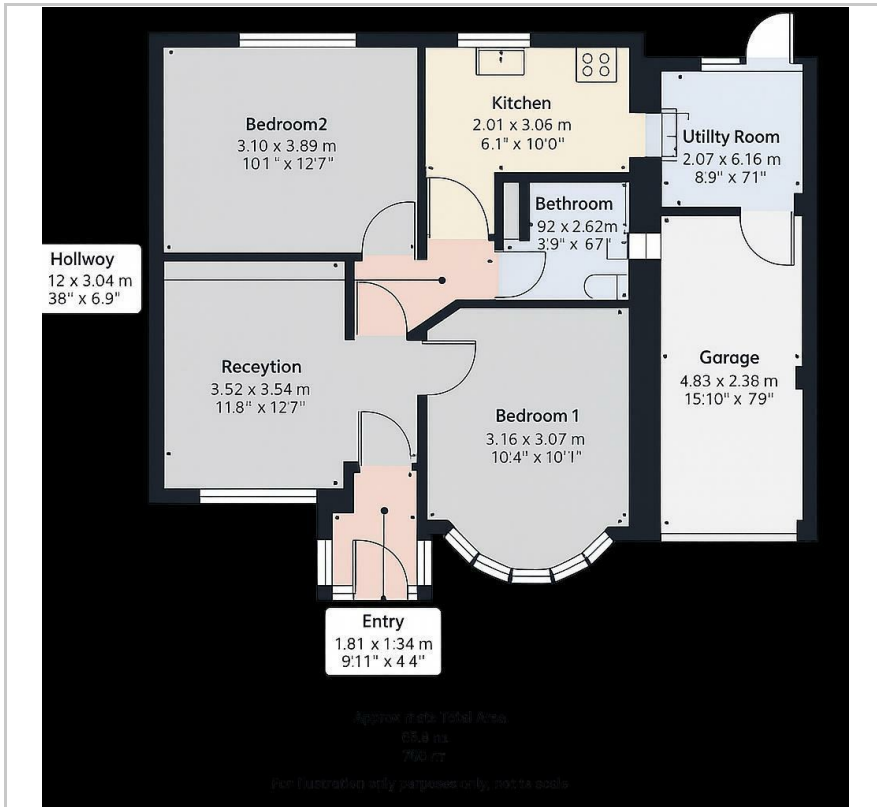

Area Map



Energy Efficiency Rating

	Current	Potential
Very energy efficient - lower running costs		
(92 plus) A		
(81-91) B		
(69-80) C		80
(55-68) D	55	
(39-54) E		
(21-38) F		
(1-20) G		
Not energy efficient - higher running costs		
England & Wales	EU Directive 2002/91/EC	



These particulars, whilst believed to be accurate are set out as a general outline only for guidance and do not constitute any part of an offer or contract. Intending purchasers should not rely on them as statements of representation of fact, but must satisfy themselves by inspection or otherwise as to their accuracy. No person in this firm's employment has the authority to make or give any representation or warranty in respect of the property.

47 The Broadway, Stanmore, HA7 4DJ

Tel: 020 8954 8806 Email: info@df-w.co.uk Website: www.df-w.co.uk